

Standard Impact Socket

A535M

○ 2-1/2"

▪ DIN 3129

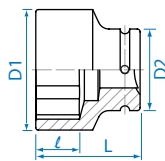

A535S

○ 2-1/2"

▪ ANSI / ASME B107.1

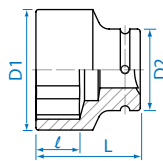

KT NO.	mm	D1 mm	D2 mm	ℓ mm	L mm	Kg	Box
A535041M	41	78	127	39	115	5.98	1 / 4
A535046M	46	83	127	39	115	5.97	1 / 4
A535050M	50	88	127	39	115	6.05	1 / 4
A535051M	51	89	127	39	115	6.06	1 / 4
A535055M	55	94	127	42	115	6.14	1 / 4
A535057M	57	96	127	42	115	6.18	1 / 4
A535060M	60	100	127	45	125	6.87	1 / 2
A535065M	65	105	127	48	125	6.90	1 / 2
A535070M	70	110	127	50	125	6.93	1 / 2
A535075M	75	115	127	55	125	7.14	1 / 2
A535076M	76	120	127	55	125	7.14	1 / 2
A535077M	77	120	127	55	125	7.15	1 / 2
A535080M	80	123	127	57	125	7.22	1 / 2
A535085M	85	127	127	60	130	7.54	1 / 2
A535086M	86	127	127	60	130	7.47	1 / 2
A535090M	90	135	127	65	130	7.90	1 / 2
A535095M	95	140	127	70	140	8.61	1 / 2
A535100M	100	145	127	70	140	8.81	1 / 2
A535105M	105	155	127	70	142	10.18	1 / 2
A535110M	110	160	127	76	155	11.50	1 / 2
A535115M	115	165	127	78	155	18.39	1 / 2
A535120M	120	175	127	80	160	13.18	1 / 1
A535125M	125	180	127	82	165	19.87	1 / 1
A535130M	130	185	127	85	170	20.64	1 / 1
A535135M	135	190	127	90	175	21.75	1 / 1
A535140M	140	200	127	95	180	24.06	1 / 1
A535145M	145	205	127	95	183	24.96	1 / 1
A535150M	150	210	127	100	190	26.91	1 / 1
A535155M	155	215	175	100	195	27.99	1 / 1
A535160M	160	225	175	100	200	31.13	1 / 1
A535165M	165	230	175	105	205	32.45	1 / 1
A535170M	170	235	175	105	205	33.15	1 / 1
A535175M	175	240	175	110	210	34.52	1 / 1
A535180M	180	250	175	110	213	38.23	1 / 1
A535185M	185	255	175	110	213	39.84	1 / 1
A535190M	190	265	175	115	220	41.49	1 / 1
A535200M	200	275	175	120	225	44.44	1 / 1
A535210M	210	285	175	125	235	48.78	1 / 1
A535215M	215	290	175	125	240	51.21	1 / 1
A535225M	225	305	175	135	250	57.57	1 / 1
A535235M	235	315	175	140	260	62.92	1 / 1

(Make - to - order production)

KT NO.	inch	D1 mm	D2 mm	ℓ mm	L mm	Kg	Box
A535076S	2-3/8	100	127	45	125	6.89	1 / 2
A535078S	2-7/16	103	127	45	125	6.93	1 / 2
A535080S	2-1/2	103	127	48	125	6.85	1 / 2
A535082S	2-9/16	105	127	48	125	6.90	1 / 2
A535084S	2-5/8	107	127	50	125	6.94	1 / 2
A535088S	2-3/4	110	127	50	125	6.93	1 / 2
A535090S	2-13/16	115	127	50	125	7.04	1 / 2
A535094S	2-15/16	115	127	55	125	7.16	1 / 2
A535096S	3	120	127	55	125	7.20	1 / 2
A535100S	3-1/8	123	127	57	125	7.26	1 / 2
A535108S	3-3/8	127	127	60	130	7.48	1 / 2
A535112S	3-1/2	135	127	65	130	7.98	1 / 2
A535120S	3-3/4	140	127	70	140	8.56	1 / 2
A535124S	3-7/8	145	127	70	140	8.65	1 / 2
A535126S	3-15/16	145	127	70	140	8.76	1 / 2
A535132S	4-1/8	155	127	70	142	9.91	1 / 2
A535136S	4-1/4	160	127	75	155	11.74	1 / 2
A535138S	4-5/16	160	127	75	155	12.52	1 / 2
A535144S	4-1/2	165	127	78	155	12.61	1 / 2
A535148S	4-5/8	175	127	80	160	19.18	1 / 1
A535156S	4-7/8	180	127	82	165	19.87	1 / 1
A535160S	5	185	127	82	165	20.02	1 / 1
A535164S	5-1/8	185	127	85	170	20.42	1 / 1
A535168S	5-1/4	190	127	90	175	21.81	1 / 1
A535172S	5-3/8	200	127	95	180	23.90	1 / 1
A535180S	5-5/8	205	127	95	183	24.43	1 / 1
A535184S	5-3/4	205	127	95	183	26.30	1 / 1
A535188S	5-7/8	210	127	100	190	26.62	1 / 1
A535192S	6	215	175	100	195	29.10	1 / 1
A535196S	6-1/8	220	175	100	195	28.69	1 / 1
A535200S	6-1/4	220	175	100	195	28.58	1 / 1
A535204S	6-3/8	225	175	100	200	30.77	1 / 1
A535208S	6-1/2	230	175	105	205	31.05	1 / 1
A535212S	6-5/8	235	175	105	205	32.17	1 / 1
A535216S	6-3/4	235	175	105	205	33.68	1 / 1
A535220S	6-7/8	240	175	110	210	32.41	1 / 1
A535224S	7	245	175	110	210	35.53	1 / 1
A535240S	7-1/2	265	175	115	220	41.16	1 / 1
A535244S	7-5/8	265	175	115	220	41.52	1 / 1
A535252S	7-7/8	275	175	120	225	44.46	1 / 1
A535256S	8	280	175	120	230	45.89	1 / 1

(Make - to - order production)